

**Solar & Wind Chart**

**Certificate No. # TGYATVNQK0-01**

Scan QR code or follow website link for rating details.

Assessor name: SANTARITA KOLLOSCH  
 Accreditation No: HERA10183  
 Property Address: 9 Schofield Close, URALLA, NSW, 2358

<https://www.fr5.com.au/QRCodeLanding?PubId=TGYATVNQK0-01>

**SITE SCRAPE ONLY APPROX. LEVELS**

PAD RL : 1009.60  
 SLAB RL : 1009.95  
 GARAGE PAD RL : 1009.428  
 GARAGE RL : 1009.778

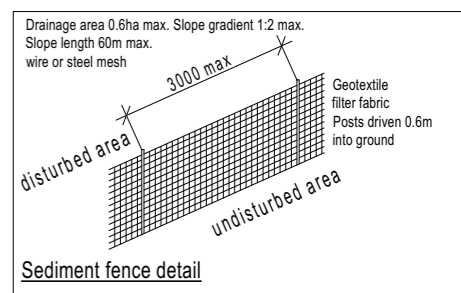

SITE COVERAGE DETAILS	
Lot size m <sup>2</sup>	814m <sup>2</sup>
Dwelling size m <sup>2</sup>	225.63 m <sup>2</sup> : 27.72% coverage
Driveway m <sup>2</sup>	121m <sup>2</sup>
Total landscaping m <sup>2</sup>	467.37m <sup>2</sup> : 57.42%
Private open space m <sup>2</sup>	292.66m <sup>2</sup>

Note : Site areas indicated may vary in definition. Basic areas or other areas indicated on these drawings used for other purposes. All areas are close approximate. Unless noted otherwise, areas not denoted as patios or driveways are vegetated areas. (gardens, lawns)

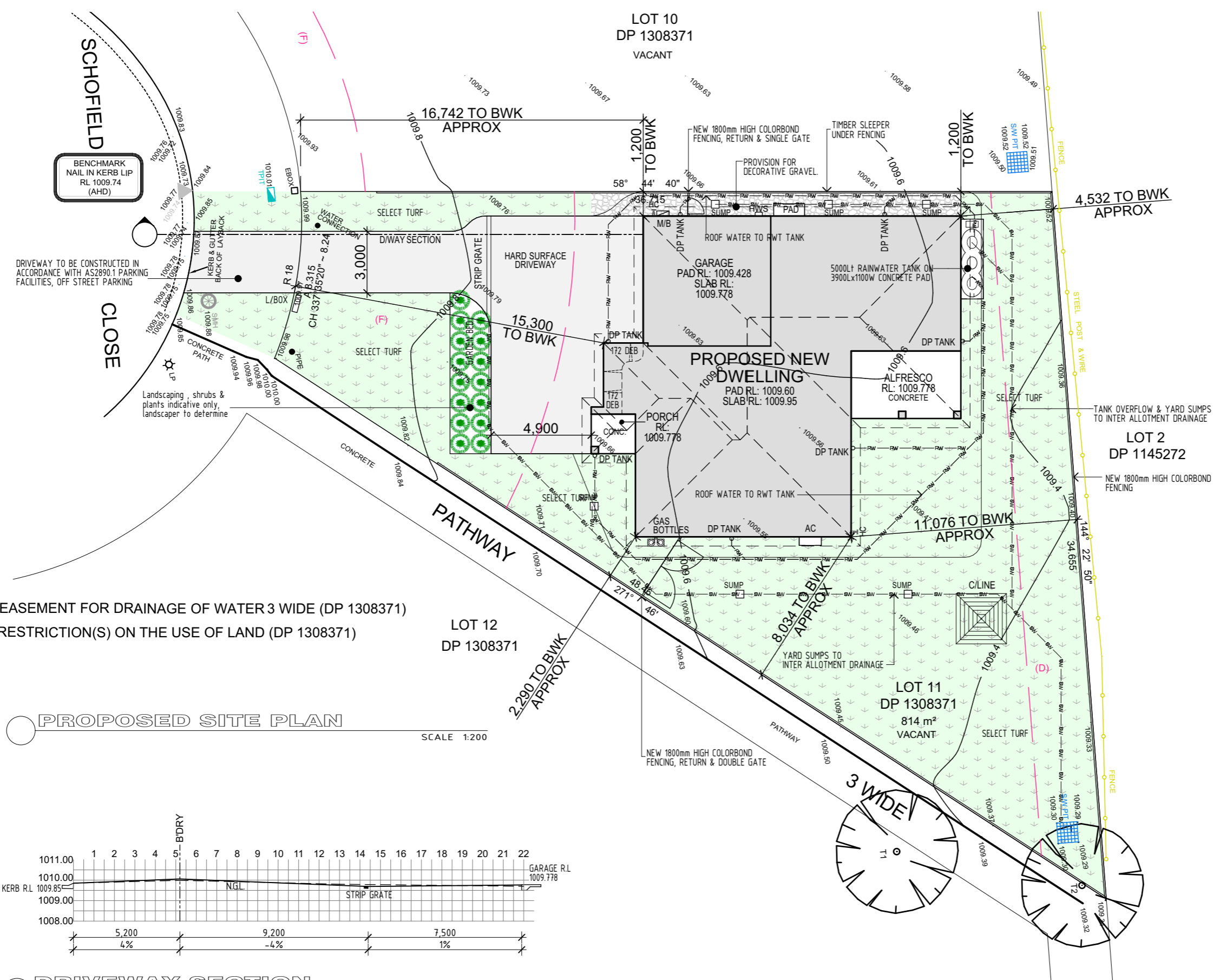

(D) - EASEMENT FOR DRAINAGE OF WATER 3 WIDE (DP 1308371)  
 (F) - RESTRICTION(S) ON THE USE OF LAND (DP 1308371)

**PROPOSED SITE PLAN** SCALE 1:200

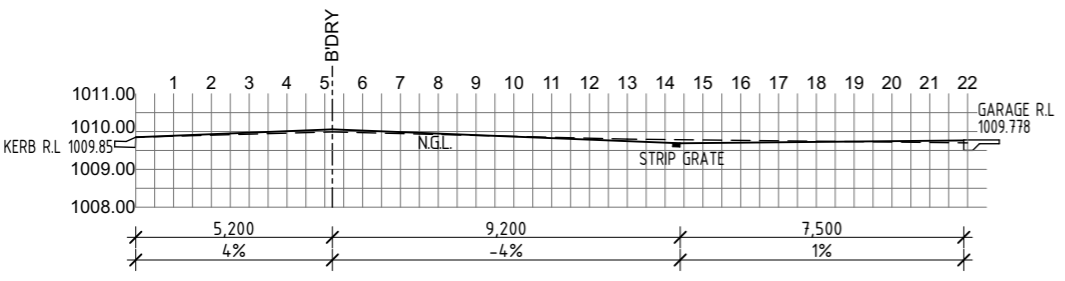

**DRIVEWAY SECTION** SCALE 1:200



**Address:**  
 130 West High Street  
 Coffs Harbour NSW 2450

**Hibbards P/L ABN 22 057 895 202**  
 E: [coffs@hibbardhomes.com.au](mailto:coffs@hibbardhomes.com.au)  
 P: (02) 6650 3300  
 F: (02) 6651 7044  
 W: [www.hibbardhomes.net.au](http://www.hibbardhomes.net.au)

**COPYRIGHT & NOTES**

figured dimensions to be used in reference to scaling - all dimensions to be checked on site. Copying of this plan is strictly prohibited without written permission of Hibbard Homes. All boundaries and contours subject to survey

DESIGN: **ALPHA 225 P01 W02 LHG**

**JOB ADDRESS**

**LOT 11 SCHOFIELD CLOSE  
 URALLA NSW 2358**

PROPOSAL: **NEW DWELLING DP: 1308371**

drawing title			PROPOSED SITE LAYOUT		
date	issue	description	JOB No.	11501	revision
17/03/26	A	ISSUED FOR CC APPROVAL	SCALE	1:200	A
-	-	-	DRAWN	ML	PAGE
-	-	-	DATE	17/03/2026	A01
-	-	-	WIND	'N2'	SITE