

Solar & Wind Chart

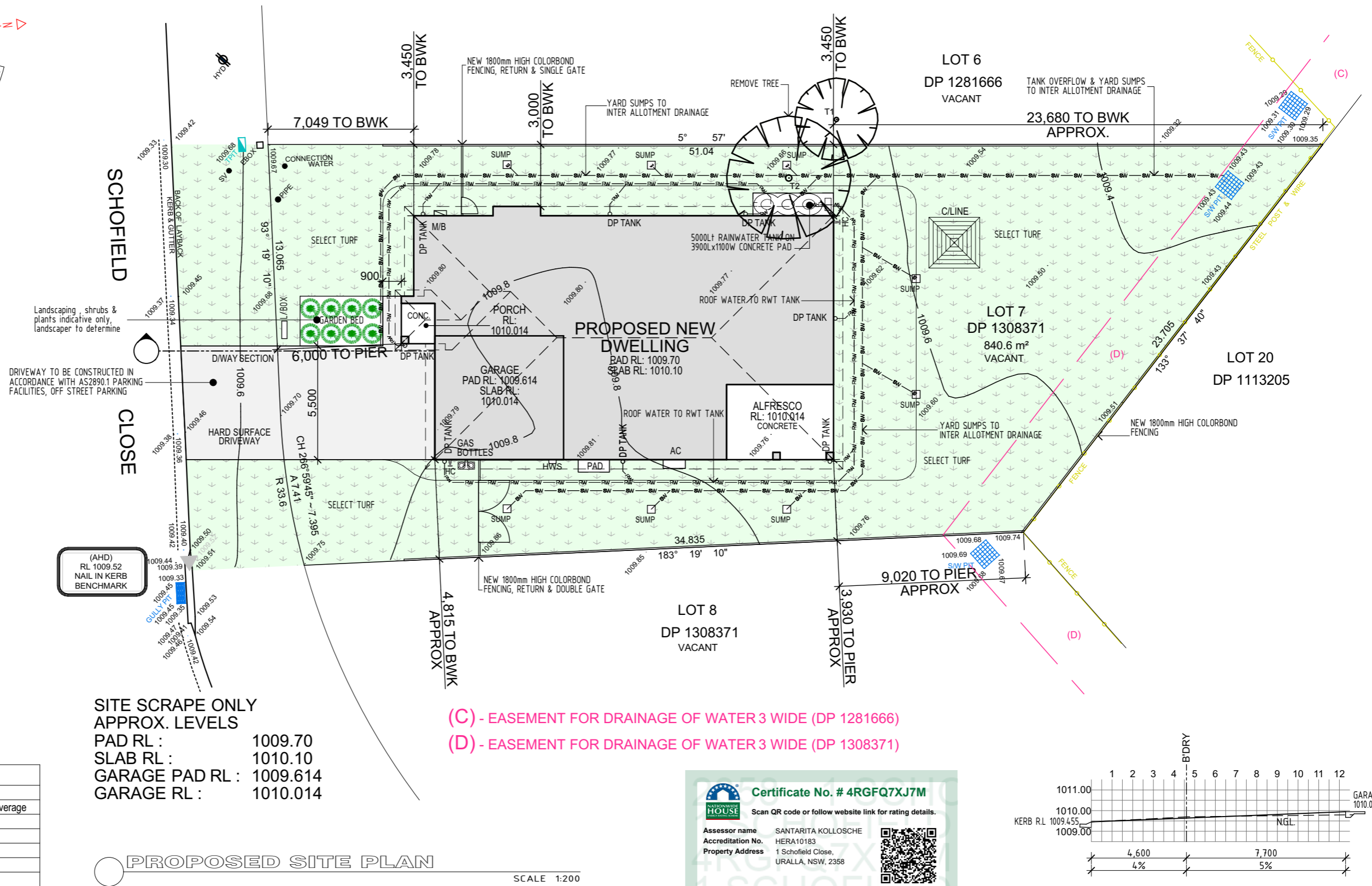

SITE SCRAPE ONLY
APPROX. LEVELS
 PAD RL : 1009.70
 SLAB RL : 1010.10
 GARAGE PAD RL : 1009.614
 GARAGE RL : 1010.014

(C) - EASEMENT FOR DRAINAGE OF WATER 3 WIDE (DP 1281666)

(D) - EASEMENT FOR DRAINAGE OF WATER 3 WIDE (DP 1308371)

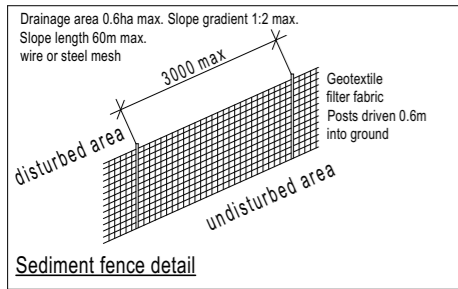

Sediment fence detail

SITE COVERAGE DETAILS	
Lot size m ²	840.60m ²
Dwelling size m ²	236.35 m ² : 28.12% coverage
Driveway m ²	43.5m ²
Total landscaping m ²	560.75m ² : 66.71%
Private open space m ²	350m ²

Note : Site areas indicated may vary in definition. Basic areas or other areas indicated on these drawings used for other purposes. All areas are close approximate. Unless noted otherwise, areas not denoted as patios or driveways are vegetated areas. (gardens, lawns)

Certificate No. # 4RFGQ7XJ7M

Scan QR code or follow website link for rating details.

Assessor name: SANTARITA KOLLOSCHIE
 Accreditation No.: HERA10183
 Property Address: 1 Schofield Close, URALLA, NSW, 2358

<https://www.fr5.com.au/QRCodeLanding?PublicId=4RFGQ7XJ7M>

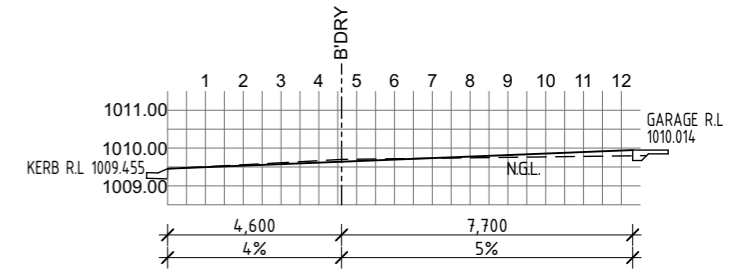

DRIVEWAY SECTION

SCALE 1:200



Address:
 130 West High Street
 Coffs Harbour NSW 2450

Hibbards P/L ABN 22 057 895 202

E:coffs@hibbards.com.au
P:(02) 6650 3300
F:(02) 6651 7044
W: www.hibbards.net.au

COPYRIGHT & NOTES

figured dimensions to be used in reference to scaling - all dimensions to be checked on site. Copying of this plan is strictly prohibited without written permission of Hibbard Homes . All boundaries and contours subject to survey

DESIGN
 KIATO 236 RP01 W02 RHG

JOB ADDRESS

LOT 7 SCHOFIELD CLOSE
URALLA NSW 2358

PROPOSAL NEW DWELLING **DP:** 1308371

drawing title			PROPOSED SITE LAYOUT		
date	issue	description	JOB No.	11500	revision
17/03/26	A	ISSUED FOR CC APPROVAL	SCALE	1:200	A
			DRAWN	ML	PAGE
			DATE	17/03/2026	A01
			WIND	'N2'	SITE