

LOT 75  
DP249072

LOT 83  
DP249072

LOT 74  
DP249072

LOT 84  
DP249072

LOT 73  
DP249072

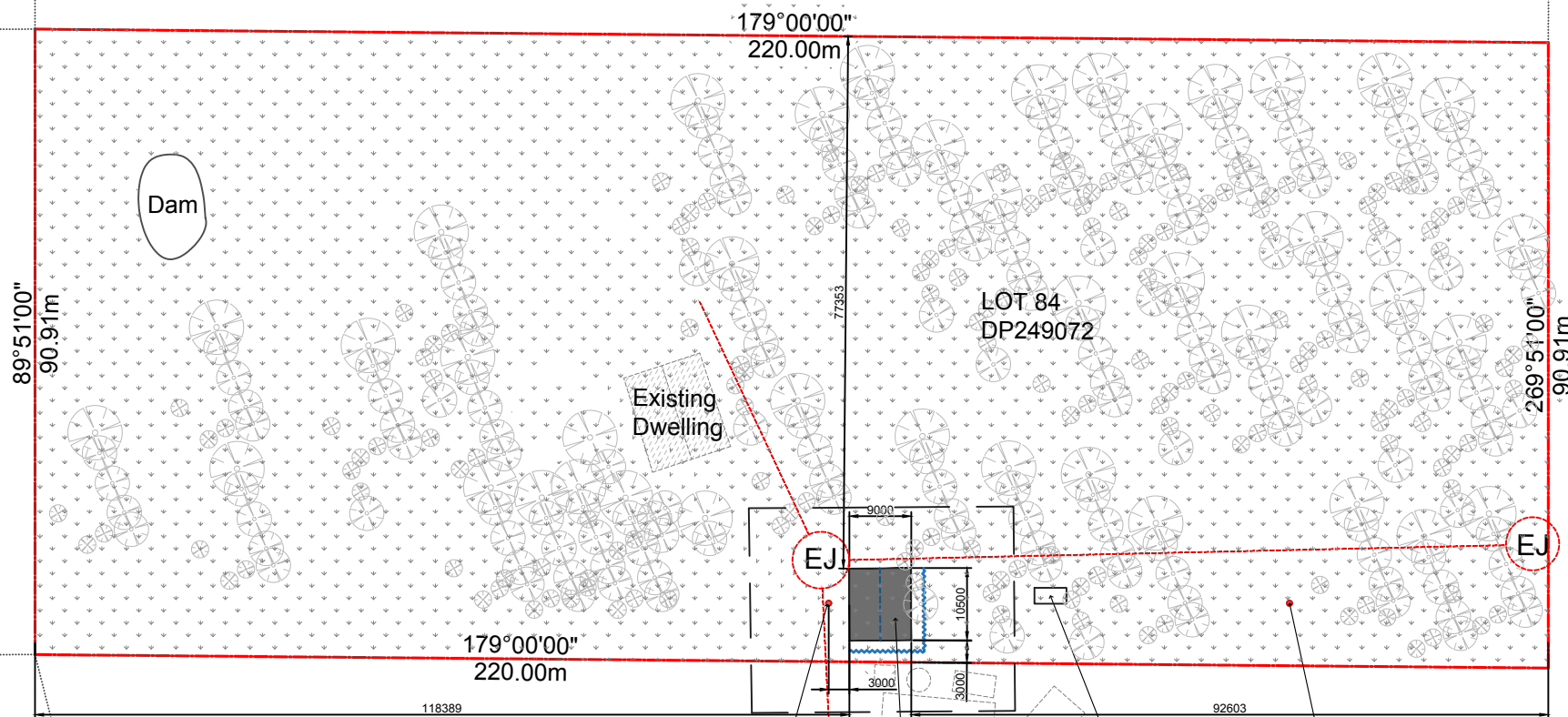

**SEDIMENT TRAPPING DEVICES.**

**SEDIMENT FENCES**



**DESCRIPTION**

A sediment fence (also known as a silt fence) is a temporary barrier of geotextile filter or fabric, usually supported by steel mesh and steel posts.

**DESIGN LIMITATIONS**

- Sediment Fences have the following design limits:
- ... The area draining to the fence is 0.6ha or less.
- ... The maximum slope length behind the fence is 60m.

**PURPOSE**

Sediment fences filter runoff, trapping the sediment and allowing filtered water to pass through.

**INSTALLATION**

Sediment fences should have a stable outlet or overflow point, in case the flow rates exceed their capacity to filter the water.

**MAINTENANCE**

After each rain event check for undercutting, sagging and overtopping, and repair immediately. Sediment collected should be removed from site.



**Site Plan**

1:1000

Supplied By:

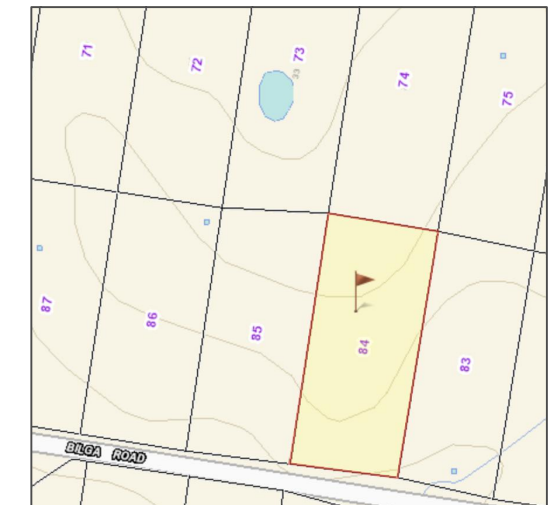

**Locality Map**

NTS



Area Ratios: **Property Size =20,000m<sup>2</sup> (2 ha)**

	Proposed Detached Shed = 94.5m <sup>2</sup> (0.47%)
	Existing Dwelling = 169m <sup>2</sup> (0.85%)
	Free Space Approx. = 19736.5m <sup>2</sup> (98.68%)

Total Site Coverage = 263.5m<sup>2</sup> (1.32%)



fernleighdrafting.com.au

hello@fernleighdrafting.com.au

**Proposed:** Detached Steel Frame Shed  
**Client:** Georgina Cleanthous  
**Address:** 54 Bilga Road Invergowrie  
 Lot 84 / DP249072  
**Council:** Uralla Shire Council



**Plan:** **Site Plan**

**Drawn:** RP  
**Date:** November 2024  
**Scale:** 1:1000 @ A3  
**Job No:** 241102

**Sheet :**  
**Of :** 01  
**06**

**Note:** Plans to be printed on A3 to be too scale. Do not scale off plans. All dimensions to be checked and verified on site.